

SITE PLAN AT PREMISES NO:- 144F, GANAPATI SUR SARANI, P.S.- SINTHEE, WARD NO-002, BOROUGH NO :- I, KOLKATA:- 700050, UNDER KOLKATA MUNICIPAL CORPORATION.

ASSESSEE NO-110022505154

AREA OF LAND :- 6 K. - 04 CH.- 37 SQ.FT. = 421.498 SQM.

HEIGHT OF THE BUILDING = 15.50 MTR.



N

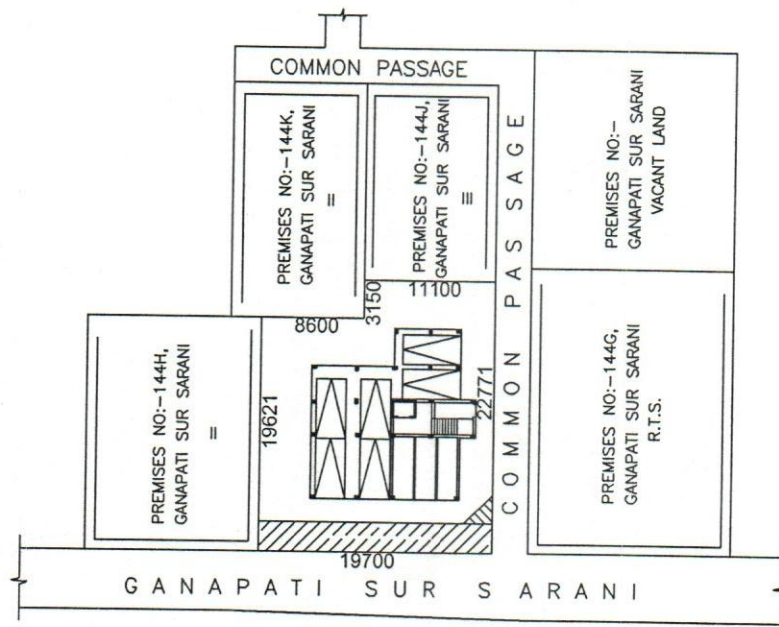

SITE PLAN

SCALE:1:600

*Tapan Banerjee*  
*Jishankar Banerjee*

TAPENDRA NATH BANERJEE, TIRTHANKAR BANERJEE  
AS CONSTITUTED POWER OF ATTORNEY  
PRAKASH SAMANTA, SUBHASH SAMANTA, BIKASH SAMANTA  
ADHASH SAMANTA, SABITA SAMANTA, NAMITA SAHA,  
ANJU SAMANTA, ARPAN SAMANTA, ARUP KUMAR DALUI  
PRIYAMITA DALUI, KUMKUM DAS

SIGN. OF OWNER/APPLICANT

*Bablu Biswas*

BABLU BISWAS  
B.TECH(CIVIL), M.TECH(GEO), MIE, M.I.G.S  
CHARTERED ENGINEER(M-1786908)  
ENLISTED LBS OF  
KOLKATA MUNICIPAL CORPORATION  
LICENCE NO-1150, CLASS-I

SIGN. OF L.B.S.

HOUSE DRAINAGE PLAN AT PREMISES NO:- 144F, GANAPATI SUR SARANI, P.S.- SINTHEE, WARD NO :- 002, BOROUGH NO :- I, KOLKATA :- 700050, UNDER KOLKATA MUNICIPAL CORPORATION.

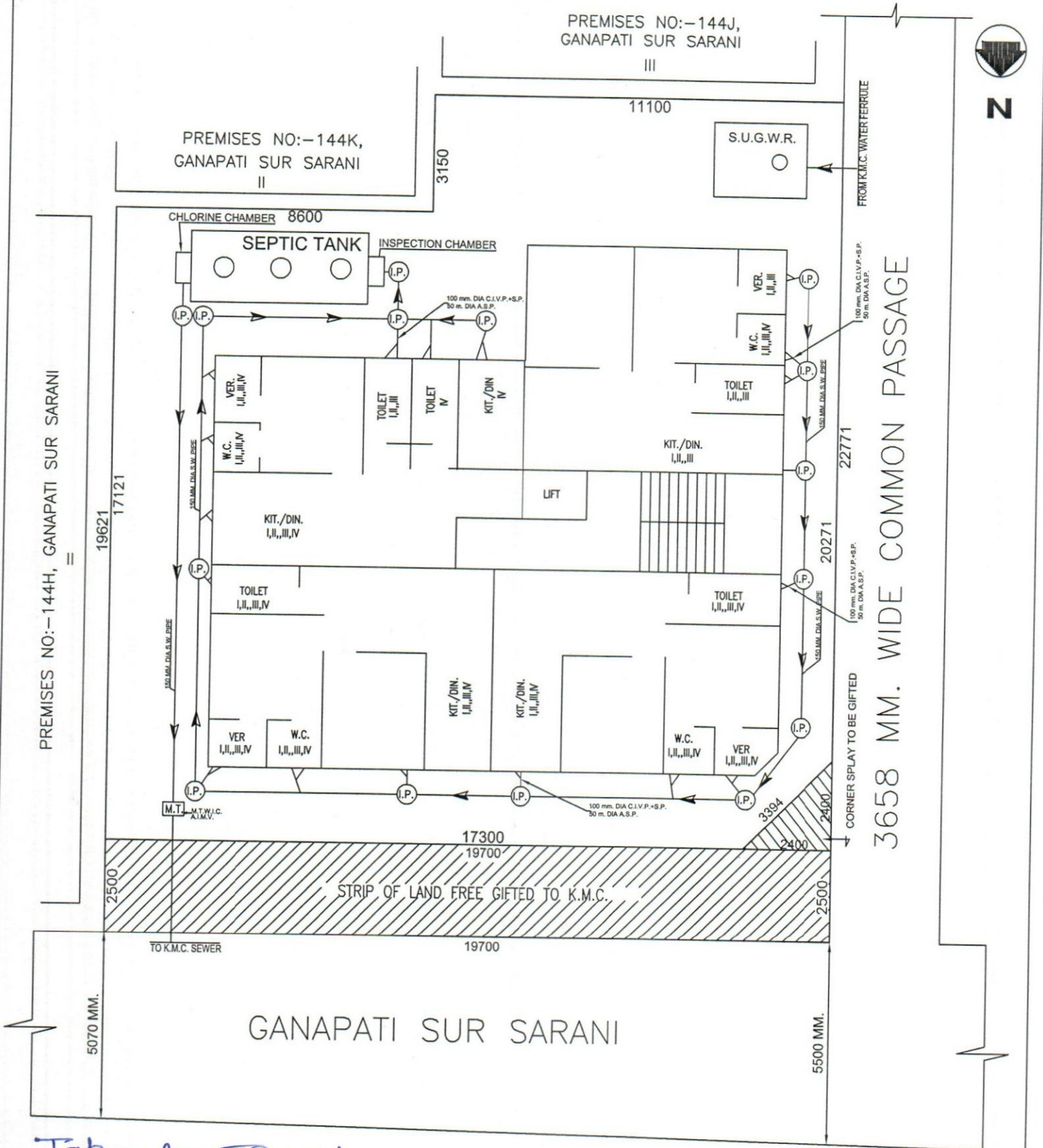

HOUSE DRAINAGE PLAN

SCALE : 1:150

*Tapan Banerjee*  
*Jishankar Banerjee*  
 TAPENDRA NATH BANERJEE, TIRTHANKAR BANERJEE  
 AS CONSTITUTED POWER OF ATTORNEY  
 PRAKASH SAMANTA, SUBHASH SAMANTA, BIKASH SAMANTA  
 ADISH SAMANTA, SABITA SAMANTA, NAMITA SAHA,  
 ANJU SAMANTA, ARPAN SAMANTA, ARUP KUMAR DALUI  
 PRIYAMITA DALUI, KUMKUM DAS

SIGN. OF OWNER/APPLICANT

*Bablu Biswas*  
**BABLU BISWAS**  
 B.TECH(CIVIL), M.TECH(GEO), MIE, M.I.G.S  
 CHARTERED ENGINEER(M-1786908)  
 ENLISTED LBS OF  
 KOLKATA MUNICIPAL CORPORATION  
 LICENCE NO-1150, CLASS-I

SIGN. OF L.B.S.